

**PROPOSED GENERAL INDUSTRIAL LAY OUT PLAN OF (A) R.S.NO. 723 & (B) R.S.NO. 724 TOTAL LAND AREA 44512.00 SQ.MT., AT VILLAGE:- SHAPAR, TALUKA:- KOTDA SANGANI, DISTRICT:- RAJKOT.**

ZONE :- INDUSTRIAL AS PER D.P.-2011  
PURPOSE:- FOR GENERAL INDUSTRIAL USE ONLY

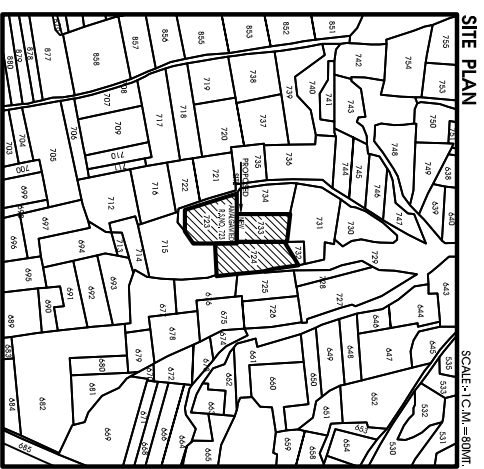
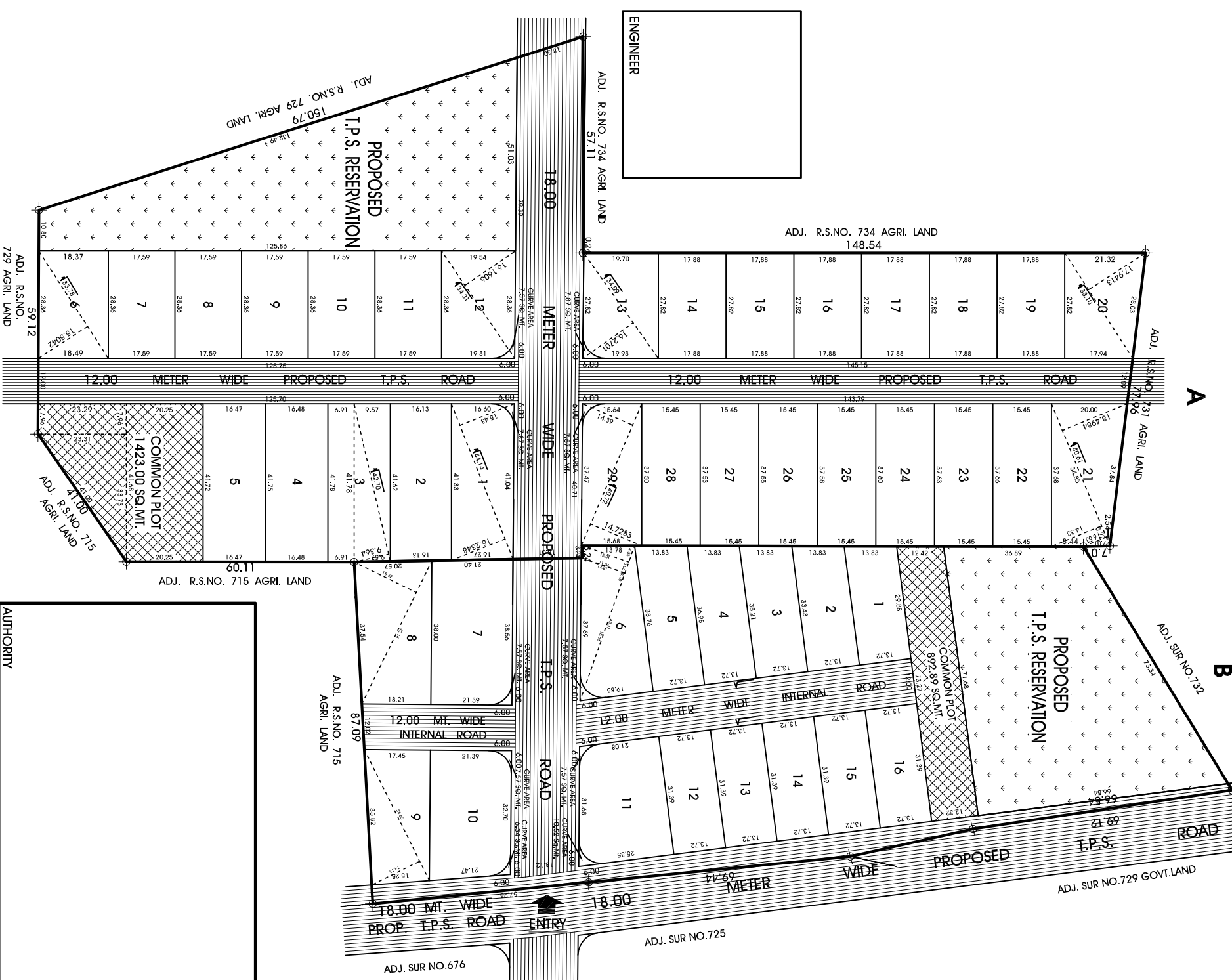

SITE PLAN

SCALE:- 1:CM=50MT

**AREA TABLE**

(A) SUMMARY AND DETAILS OF LAND AREA

COMPIERS TOTAL LAND AREA AS PER RECORD	SQ.MT.	SQ.MT.
TOTAL AREA OF EXIST. NEW MANAGED LAND	21282.00	32702.00
AREA RESERVED FOR PROPOSED T.P.S. RESERVATION & ROAD CORR.	9222.15	11442.22
NET LAND AREA (95%) :-	11759.85	21261.11

**AREA TABLE: A**

(B) AREA TABLE (AS PER PLAN)

SER. NO.	AREA SQ.MT.	SER. NO.	AREA SQ.MT.	SER. NO.	AREA SQ.MT.
1	628.90	11	409.48	21	657.19
2	628.90	12	624.48	22	628.20
3	628.90	13	624.48	23	628.20
4	628.90	14	624.48	24	628.20
5	628.90	15	624.48	25	628.20
6	628.90	16	624.48	26	628.20
7	628.90	17	624.48	27	628.20
8	628.90	18	624.48	28	628.20
9	628.90	19	624.48	29	628.20
10	628.90	20	624.48		
<b>TOTAL PLOT AREA</b>	<b>12633.45</b>		<b>12633.45</b>		
<b>COMMON PLOT AREA</b>	<b>12320.00</b>		<b>12320.00</b>		
<b>NET LAND AREA (95%) :-</b>	<b>11776.85</b>		<b>11776.85</b>		

**AREA TABLE: B**

NO	AREA SQ.MT.	NO	AREA SQ.MT.
1	422.16	9	573.98
2	446.51	10	704.53
3	470.87	11	770.48
4	495.22	12	430.68
5	519.17	13	430.68
6	655.71	14	430.68
7	810.98	15	430.68
8	731.99	16	430.68
<b>TOTAL PLOT AREA 1 TO 16 :-</b>	<b>8693.00</b>		<b>8693.00</b>
<b>COMMON PLOT AREA :-</b>	<b>892.89</b>		<b>892.89</b>
<b>INTERNAL ROAD AREA :-</b>	<b>1158.06</b>		<b>1158.06</b>
<b>NET LAND AREA (95%) :-</b>	<b>1159.05</b>		<b>1159.05</b>

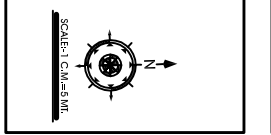

**OWNER**

MANSUKHBHAI GHELABHAI SAVALIYA

SANJAYBHAI MANSUKHBHAI SAVALIYA

KIRANBHAI VEJULAL KOYANI

JAYANTIBHAI BABUBHAI KACHHADIYA